

ZAZA2 PBJ

Revêt déposé/Patent déposit

AVANTAGES/ADVANTAGES

- Facile et simple à installer
Easy to install
- 1 Sans SERRE-CÂBLE!
No CLAMP
- 1 Sans maintenance
No maintenance

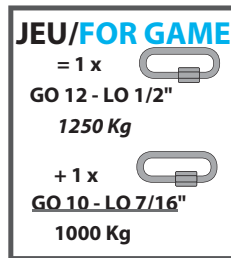
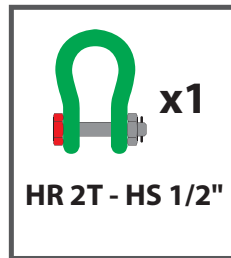
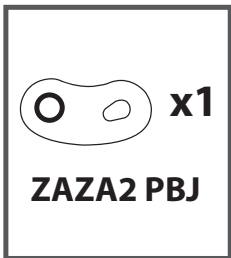
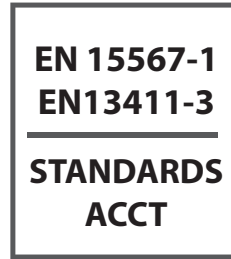
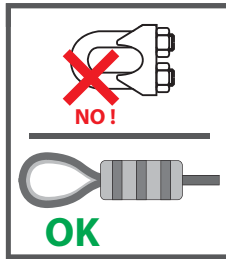
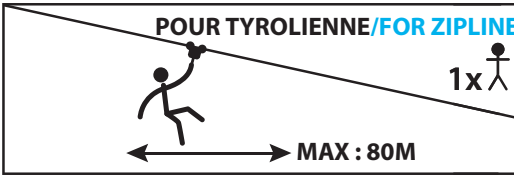
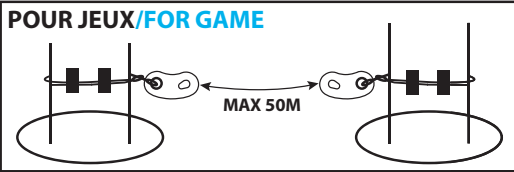

OU

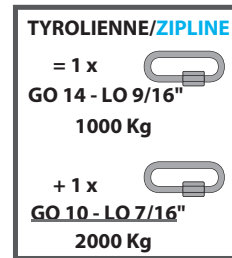

EXEMPLES DE SYSTEMES DE FIXATIONS
FIXATION EXAMPLE

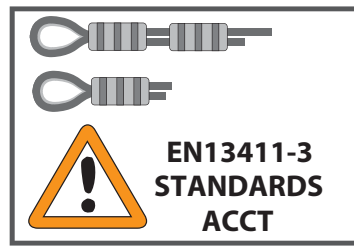
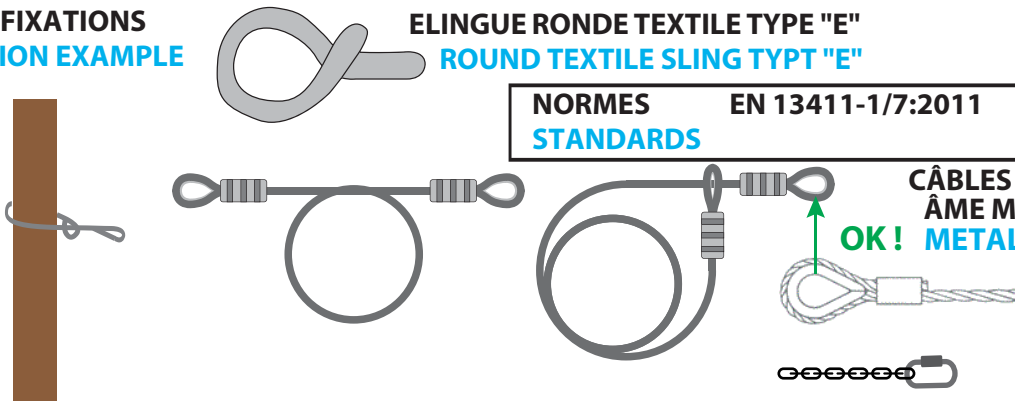

Operation 1

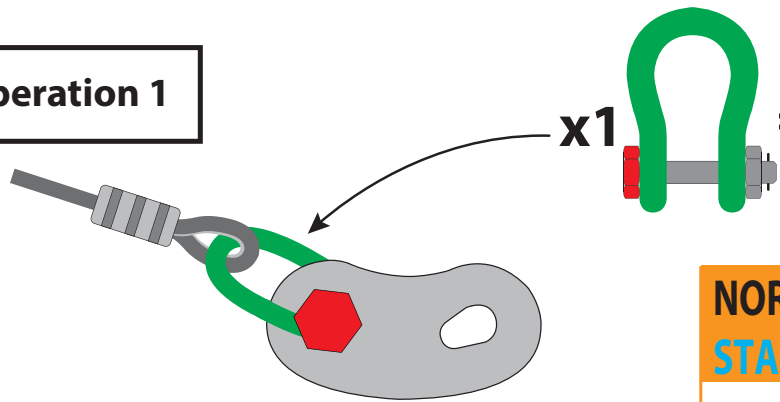

NORMES DE MONTAGE
STANDARDS OF ASSEMBLY

EN 15567-1:2015
 EN 13411-3:2011
 STANDARDS - ACCT

Operation 2

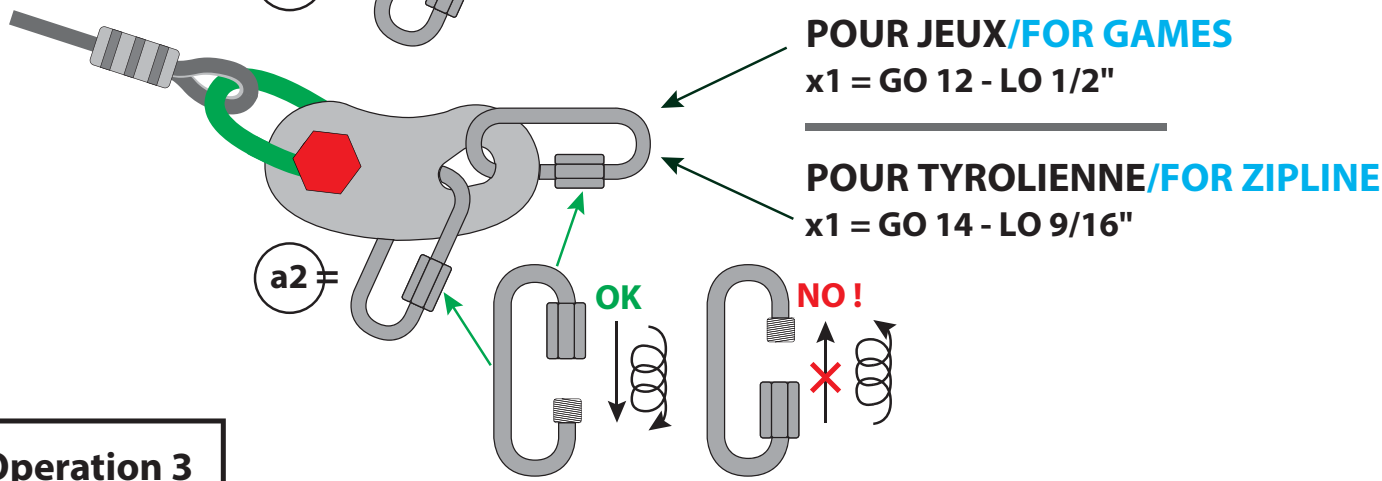
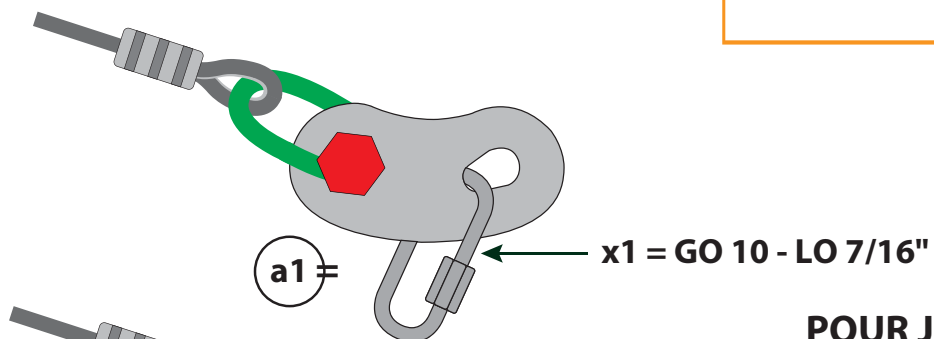

Operation 3

● INSTALLATION DE LA PLATINE DE DEPART
INSTALLATION of STARTING PLATE

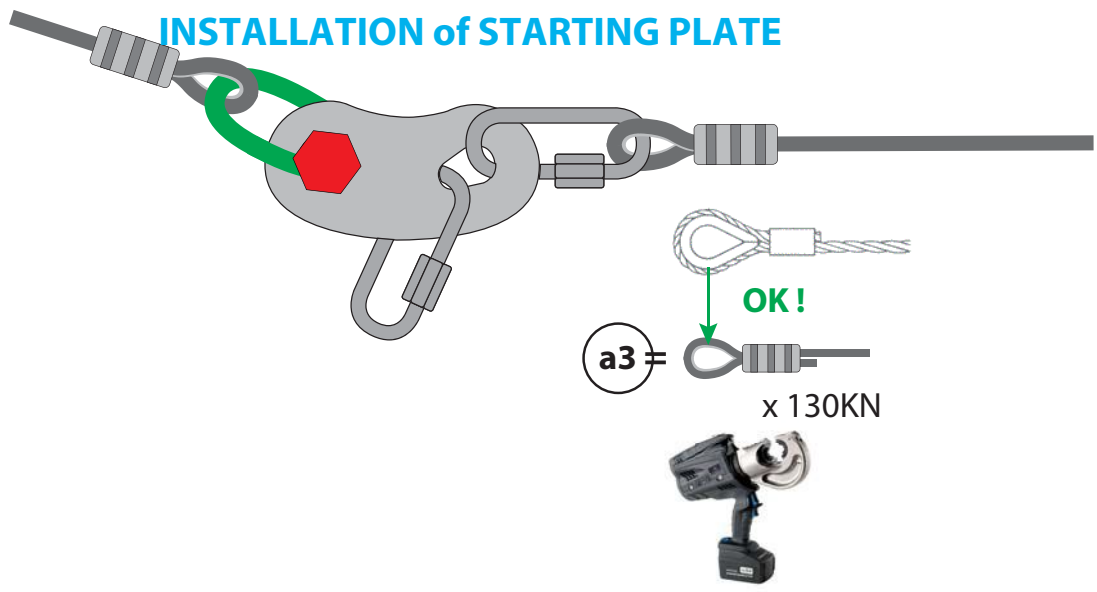

Operation 4

- **INSTALLATION DE LA PLATINE D'ARRIVEE**
INSTALLATION of ARRIVALL PLATE

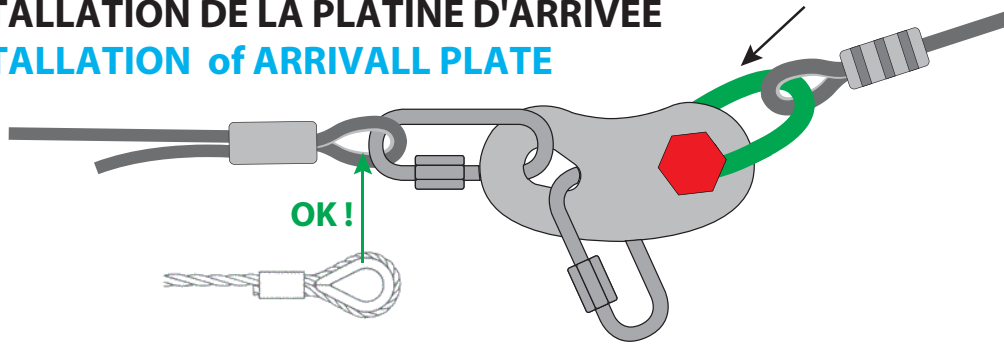

Operation 5

- **TENSION DU CÂBLE**
CABLE TENSION

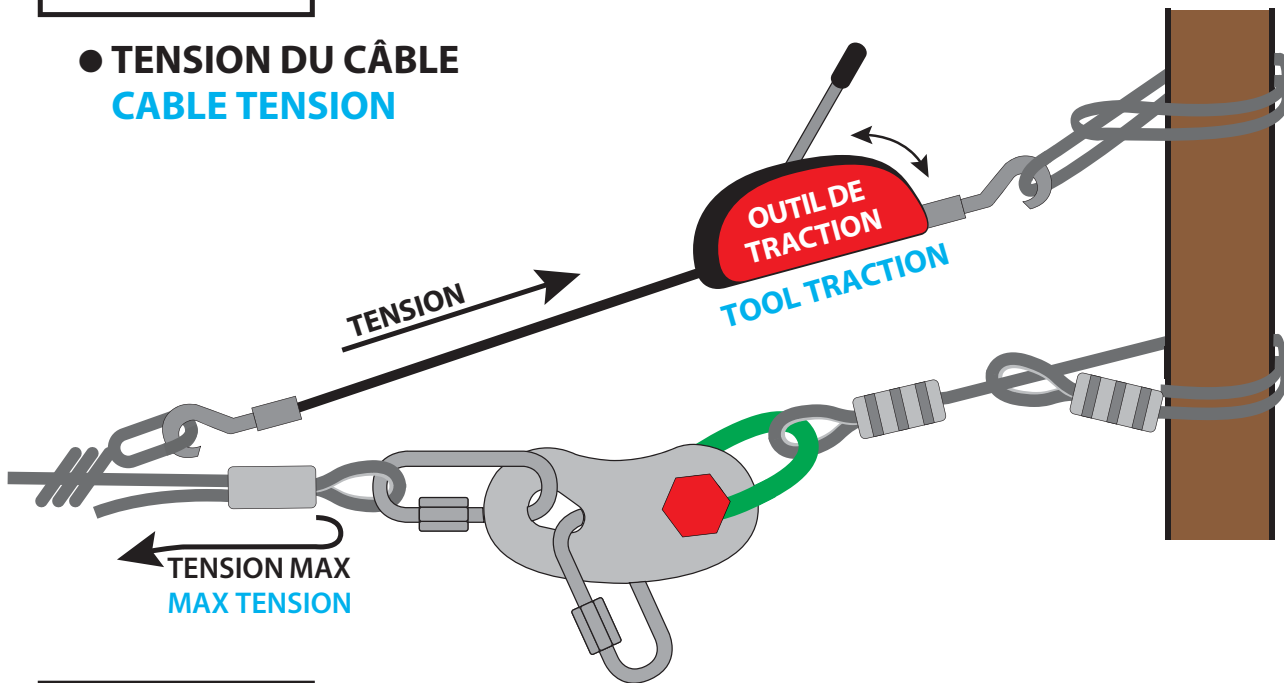

Operation 6

- **POUR SERTIR**
TO CRIMP

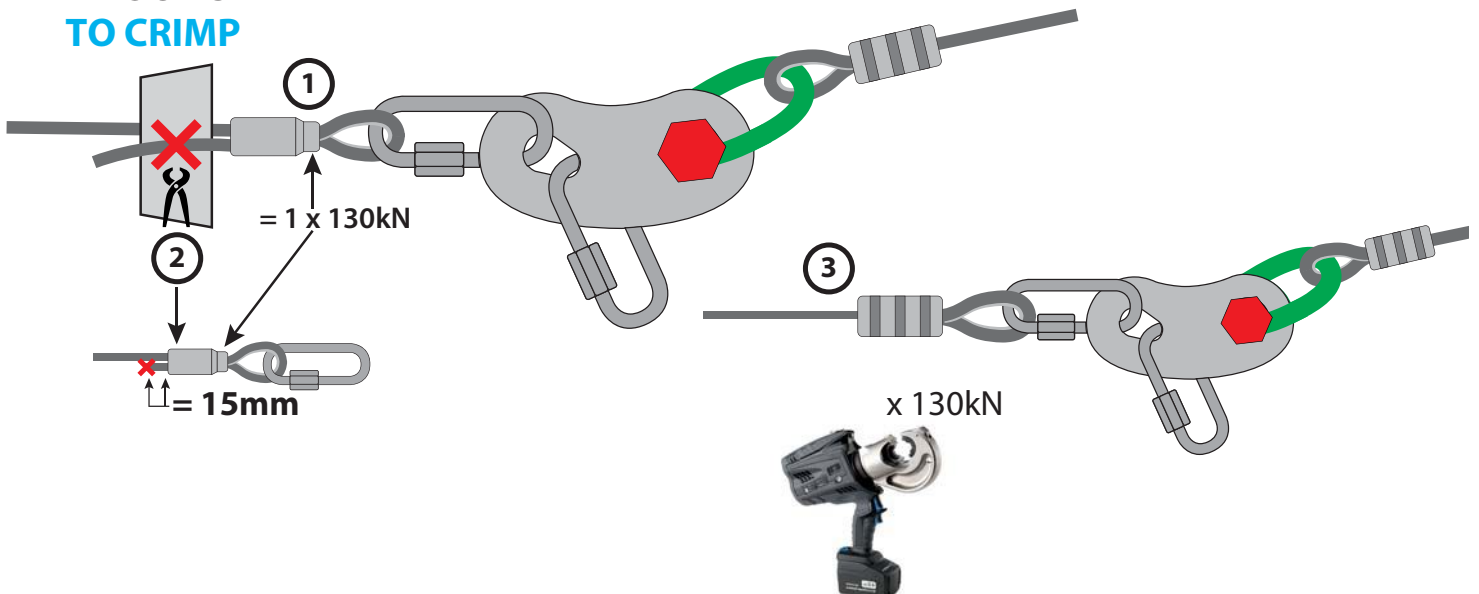

Operation 7

- **OPTION:**
SYSTEME DE TENSION = POUR TYROLIENNE
TENSION SYSTEM = FOR ZIPLINE

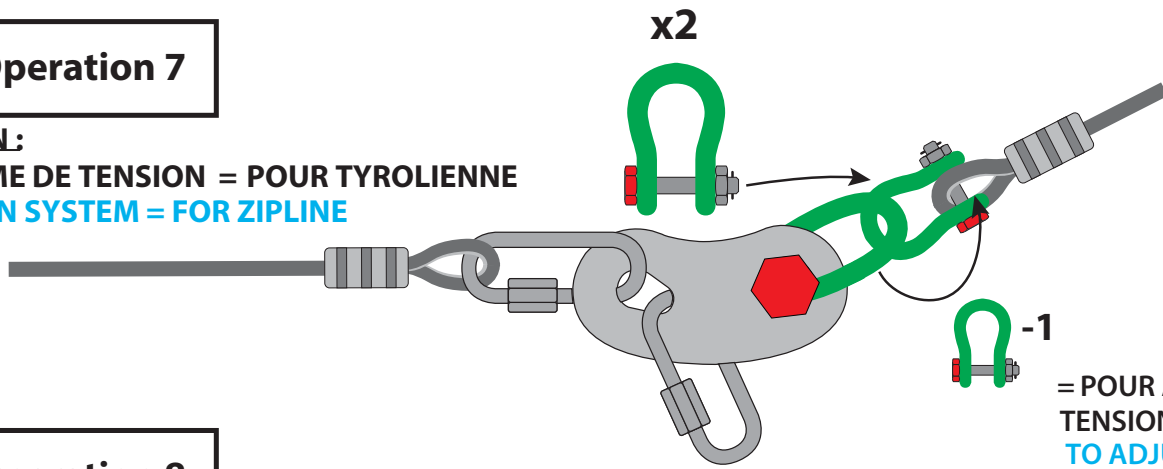

= POUR AJUSTER LA
TENSION DU CÂBLE
TO ADJUST CABLE
TENSION

Operation 8

- **RECOMMANDATION DE MONTAGE**
RECOMMANDATION ASSEMBLY

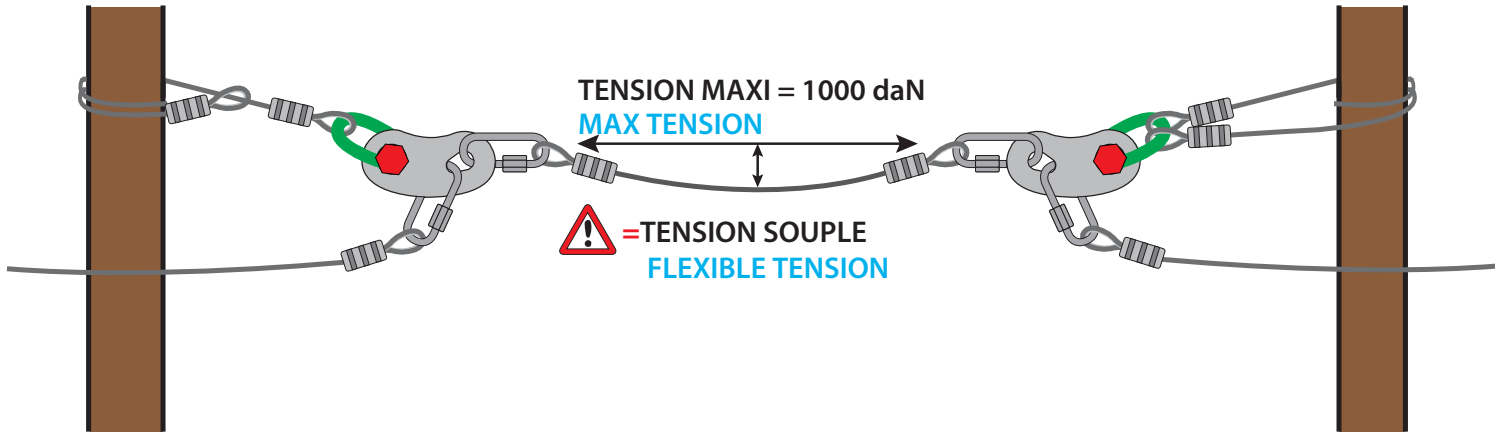

Operation 9

- **JONCTION**
JUNCTION

Exemples (non contractuel)
de systèmes de fixations
NOT contractual Examples
system for fixation

